

CLOSE IN SE BUILDING FOR SALE

810 SE Belmont, Portland, OR



Available:

9,760 sq ft total
5,030 sq ft warehouse
4,700 sq ft office

Price: \$1.5 million

The building is located in the Central Eastside Urban Renewal District, and may be eligible for various financial assistance programs through the Portland Development Commission.

The building, built in 1970, is constructed of wood and concrete masonry with 15 foot ceilings, carpeting and large storefront windows. Surface parking for about 20 cars. (see reverse for floor plan)

Features include:

- Storefront windows
- 20,000 sq ft lot
- 10,000 sq ft parking
- Back is fenced/gated
- 15 ft ceilings
- 2 grade overhead doors
- HVAC
- Three restrooms
- Zoned IG1
- Traffic count: 12,000/day
- 2006 taxes: \$10,918

Craig Kelly

322 NW Fifth Ave, Suite 301
Portland, Oregon 97209
Phone (503)224-2446 Fax (503)224-2311
www.venerableproperties.com

810 SE Belmont
9,760 sq ft

Restaurant, Retail, Office, Warehouse

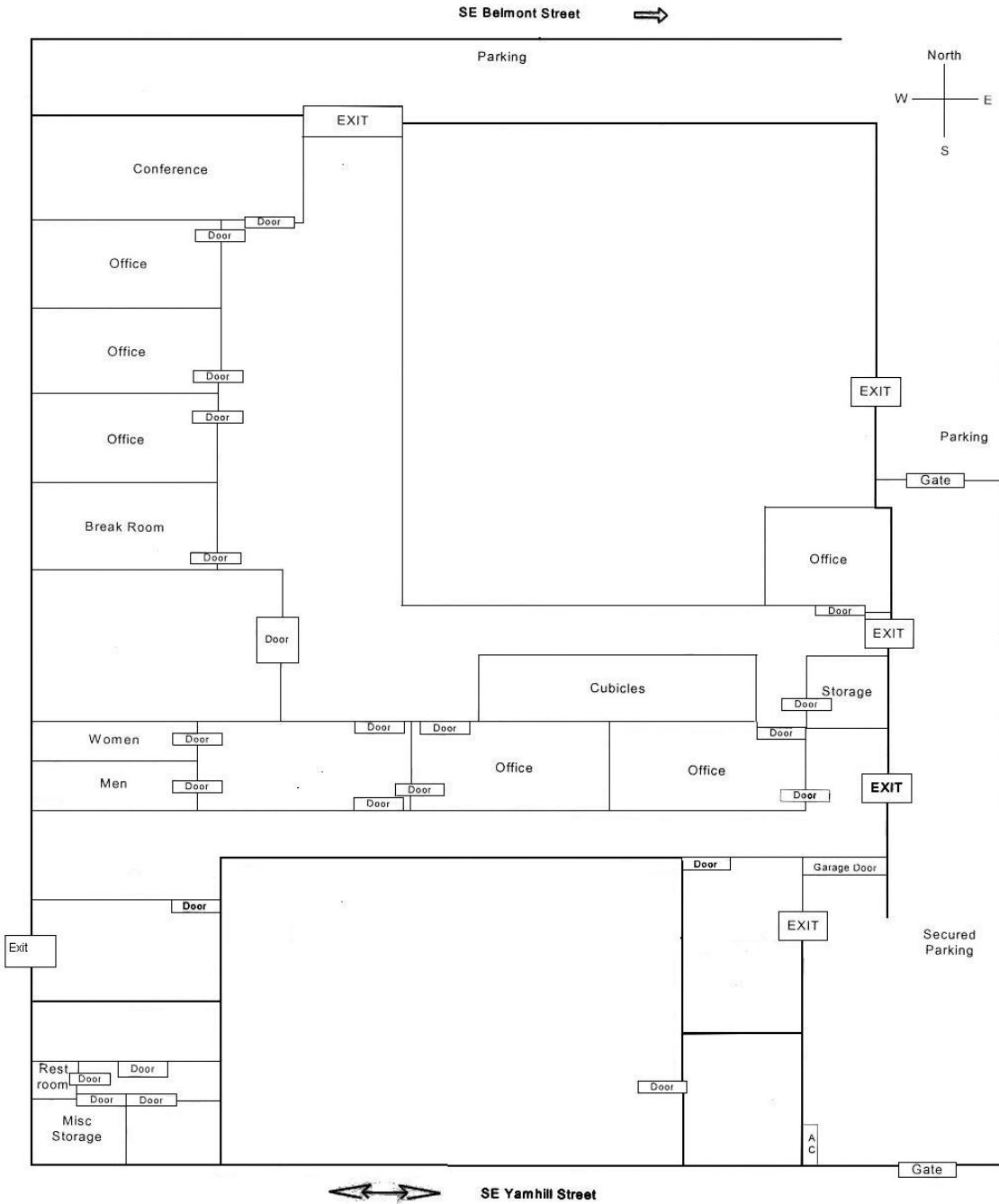

All information is deemed reliable but its accuracy is not guaranteed. Floor plan is approximate, not drawn to scale.